

MANMACHINE[®]

Working today for a cleaner tomorrow[®]

SINGLE WINDOW AUTOMOTIVE CLEANING SOLUTIONS



**COMPLETE
CAR CARE
SOLUTION**



**MANMACHINE
SPIRIT**

MANMACHINE

Working today for a cleaner tomorrow™

MANMACHINE WORKS

Changing the face of cleaning...

MANMACHINE GROUP

Founded in 1987, with vision and determination as the only capital to change the face of Cleaning Industry. Beginning as a contract cleaning company, Manmachine evolved into a full-fledged mechanized cleaning solutions company by bringing to fore fresh concepts, global brands and latest technology as innovative solutions. Eventually expanding with Express Carwash, Manmachine Works, Themaids.in and Manmachine Solutions, it has set a new benchmark of excellence.

MANMACHINE WORKS DRIVING THE CLEANING REVOLUTION

The name MANMACHINE WORKS is synonymous with advanced cleaning technology in India. Manmachine Works is bringing the latest and most innovative cleaning solutions for a fast changing and highly demanding automotive industry requirements. It offers not only a wide range of cleaning equipment from the world leaders but also complete cleaning solutions, starting from designing a car wash to promoting professional skills by introducing the first ever "CAR WASH COLLEGE" in India.

PARTNERING WITH WORLD-CLASS TECHNOLOGY

ANNOVI REVERBERI



Since 1958, Annovi Reverberi is leading the international market with distinguished solutions. Counted among the leading manufacturers of pressure washers, piston pumps and diaphragm pumps, it's growing by consistently pursuing Quality and Performance. AR pumps can be found wherever quality, professionalism and service are required. Because every product that bears the AR name is the result of a modern, flexible corporate organization, that can put specific departments and expertise to work for each customer.

ELSEA



Founded by a group of young entrepreneurs in 2001, ELSEA's expanded range of products are internationally certified by ISO 9001:2008, TUV-GS, CTUVs & GOST with a widespread presence around the world.

ISTOBAL



Founded in 1950, the company commands presence in more than 62 countries with more than 500 employees and an impressive legacy of more than 64 years of manufacturing automatic car washing machines. With premium products like M'Start, the company has earned staunch credibility and recognition around the world.

STEAMJET



"STEAMJET prepares for a better future and a better environment." STEAMJET is NOT an ordinary steam generator. It is the product of 10 years of research, development and delicately patented design for superior steam car wash. STEAMJET is now sold worldwide gaining great reputations with its quality and performance. With a global network of 20 countries, the company is running a number of distributors and dealers around the world.

Manmachine cares about people and environment, and we are committed to bring globalization to the cleaning industry in India.

MANMACHINE MAKES YOU GAIN THE EDGE IN CUSTOMER SATISFACTION

IS YOUR CAR WASH BUSINESS FACING THESE PROBLEMS

Non-professionally designed bay wash area

Wastage of water, power and wash space

Unskilled labour

Lack of awareness on latest car wash technology and equipment

Wastage of time due to unsystematic wash process

Hoses/Accessories and other equipment lying on floors

Need to outsource washing

Regular customer complaints

Low CSI ratings

IT'S TIME TO UPGRADE YOUR SERVICE AND EQUIPMENT TO WORLD-CLASS CAR WASH SOLUTIONS

Today, people have less time to spend on errands such as car wash. The educated customers are aware of their options and demand more value for money. So, the challenge is to provide customers with clean cars in minimal time and also the best possible quality of wash.

Let your customers experience how automated the process is, how quickly it gets done and how 'little work' is actually required to drive home a car shining as brand new.

Let your customers experience the Manmachine Difference - the one stop solutions provider in car wash with state-of-the-art machines, highly trained professionals and global car care products.



Car workshops and showrooms wash bay area needs scientific layout plan which is essential for efficient functioning and relaying of car wash services. Poor planning, shoddy arrangement and mismanagement is the primary cause for wastage of wash space, electricity and water resources. Manmachine addresses your workshop/showroom problems by first designing the washing bay area. Our in-house expert team of professionals plans the architecture of the bay area by understanding its capacity and processes.

- ❑ Area required to accommodate the required number of cars.
- ❑ Water & electricity requirement of the machinery and equipment.
- ❑ Meticulous considerations such as slope of the bay area to make sure that no water accumulates on it and the operators have a clean bay to work upon.
- ❑ Proper drainage system to avoid blockage.
- ❑ Increase work efficiency and employee retention by putting right accessories in the right place.

TOTAL ARCHITECTURE & DESIGN CONSULTANCY

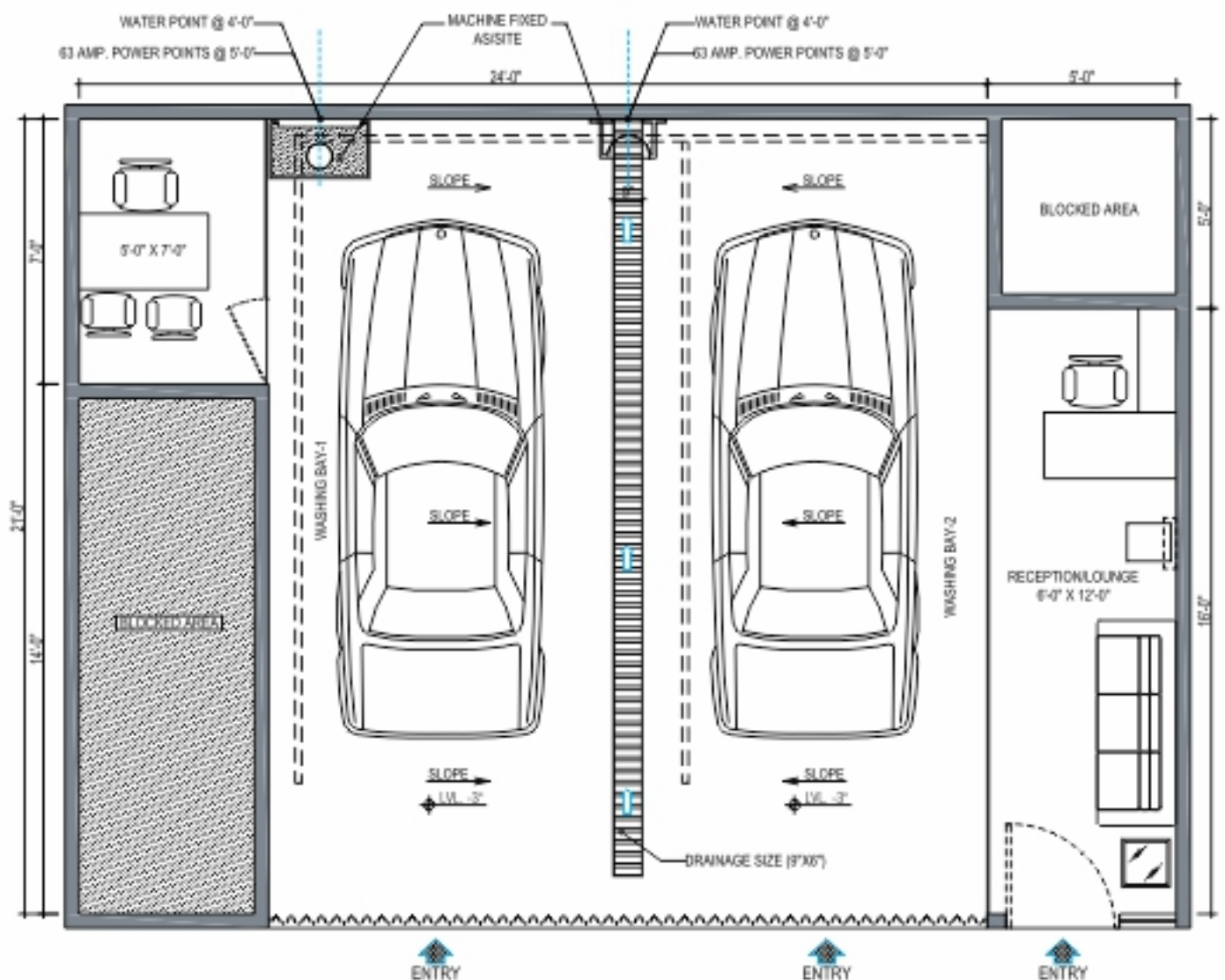

**HIGH
QUALITY**

DELIVERING SMARTER AND RESOURCE EFFICIENT HIGH PRESSURE CAR WASHERS

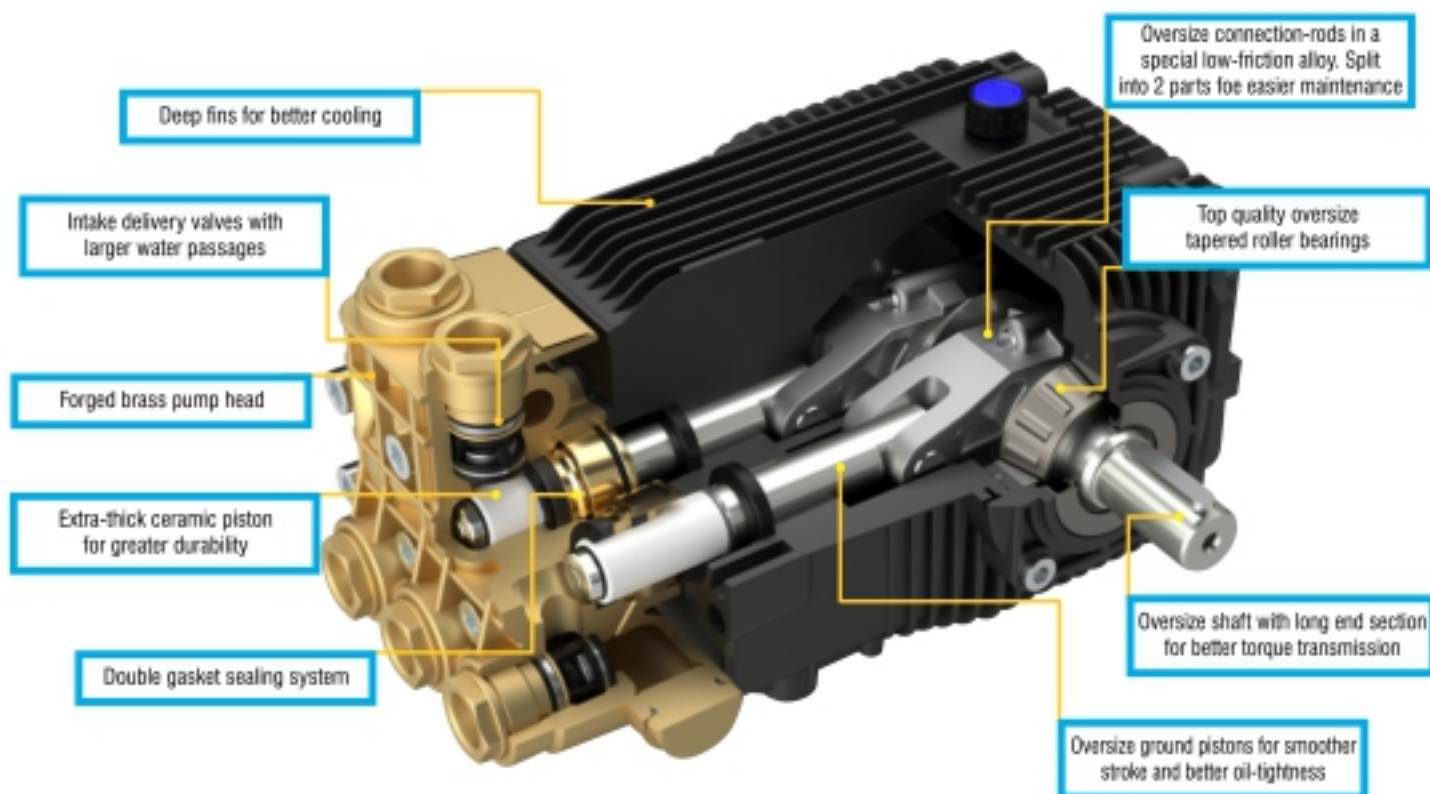

Annovi Reverberi is a leading manufacturer of pumps for high-pressure washing and complete hot and cold water high pressure washers. Years

of technological advancement, research and development has made it a prestigious leader brand in Italy and worldwide.

HRC & HRK PRO FEATURES

3-piston alternating volumetric pumps for use on cleaning units and industrial systems.

- Pump body & cover in die-cast aluminum alloy.
- Side cover with incorporate oil sight glass.
- Rear cover with oil drain outlet.
- Pistons driven by crank-connecting rod mechanism.
- Pump shaft in pressed high-strength steel.
- Oversized friction bearings.
- Connecting rods in die-cast special low-friction zinc aluminum alloy.
- One-piece ceramic pistons.
- Pump head in pressed brass.
- Double gasket sealing system.
- Intake and delivery valves have plugs for easier maintenance.
- Increase work efficiency and employee retention by putting right accessories in the right place.

HRC PRO

CAR WASH CAPACITY OF 20 - 25 CARS IN 1 DAY.



PUMP

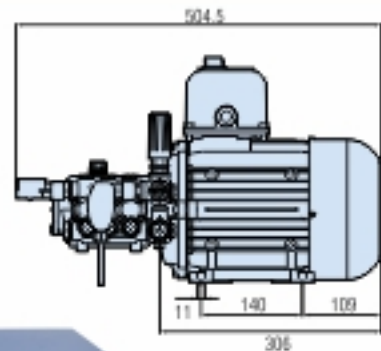

STANDARD ACCESSORIES

- ❑ Hose Pipe 10 mtrs.
- ❑ Gun with quick connect system
- ❑ Lance 500 mm
- ❑ 100 Micron Filter
- ❑ Nozzle 25°



PUMP WITH COVER

TECHNICAL SPECIFICATIONS

HRC 1450 rpm

Pump	Output		Pressure		Power		RPM	3 ~ 50 Hz	Weight
	l/min	gpm	bar	psi	hp	kw	N° giri/1'	volt	kg
HRC 12.13 ET	12	3.20	130	1900	4	3	1450	230/400	29

HRK PRO

CAR WASH CAPACITY OF 35 - 40 CARS IN 1 DAY



PUMP

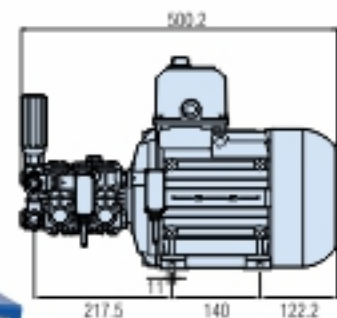

STANDARD ACCESSORIES

- ❑ Hose Pipe 10 mtrs.
- ❑ Gun with quick connect system
- ❑ Lance 500 mm
- ❑ 100 Micron Filter
- ❑ Nozzle 25°



PUMP WITH COVER

TECHNICAL SPECIFICATIONS

HRK 1450 rpm

Pump	Output		Pressure		Power		RPM	3 ~ 50 Hz	Weight
	l/min	gpm	bar	psi	hp	kw	N° giri/1'	volt	kg
HRK 11.14 ET	11	2.90	140	2000	5.5	4	1450	230/400	33



Rotating Boom

POWERFUL & EFFORTLESS HIGH PRESSURE CLEANER ACCESSORIES

- ❑ The system comprises of machines that are placed in a machine room with hoses stretching out of it through stainless steel pipes directly to the boom.
- ❑ The arrangement leads to no possibility of hoses being laid on the floor as large area of washing is done with the help of Boom Technology.
- ❑ Special rubber coated hoses stay immune to punctures and don't leave any mark or scratches on the car.
- ❑ Saves time with a quick connect system
- ❑ provided on lances, guns and foam bottle.
- ❑ Saves water and electricity with plunger pump technology. No maintenance with a total stop system after 20 secs. of release of trigger. 3kw power produces 140 bar pressure.
- ❑ Provides better car quality, takes less man hours and the usage of foam bottle gives faster coverage.
- ❑ Fast and consistent working and zero breakdowns due to parking accessories for all the attachments.



FOAM BOTTLE

- ❑ Sleek & smooth modern design
- ❑ Sight window indicates level of soap remaining
- ❑ Refillable bottle reduces environmental waste
- ❑ Vented large screw cap for easy refilling
- ❑ Comes with a QUICK CONNECT for easy attachment
- ❑ Spray pattern easily adjustable



QUICK CONNECT SYSTEM

- ❑ Without threads that may bind or only partially connect
- ❑ Automatic locking system facilitates faster access
- ❑ Suitable for confined areas
- ❑ Non-drip interface
- ❑ Minimizes unexpected downtime
- ❑ Standard with Manmachine pumps

HIGH PERFORMANCE AND PRODUCTIVITY

Rotating Boom

ROTATING BOOM

- ❑ Swivelling adapter with side and top water inlet for easy installation
- ❑ 360° / 180° continuous rotation for the car wash
- ❑ Insulated high pressure hose
- ❑ Hose guard with integrated tension release feature
- ❑ Extremely durable as zinc coated or in SS
- ❑ Improves the maintenance of pumps and pressure hose

UNDERBODY LANCE

- ❑ A right angle wash that helps clean difficult-to-reach areas
- ❑ Easily removes mud and debris from the underbody
- ❑ Underbody wash without gantry/lift
- ❑ Avoids tyres alignment and balancing problem
- ❑ Made with high grade stainless steel for long life
- ❑ Task is done in less than 3 mins.

Hose Pipe

Spray Gun

Moulded Lance

Lance Holder

STORAGE TRAY



FOAM BOTTLE HOLDER

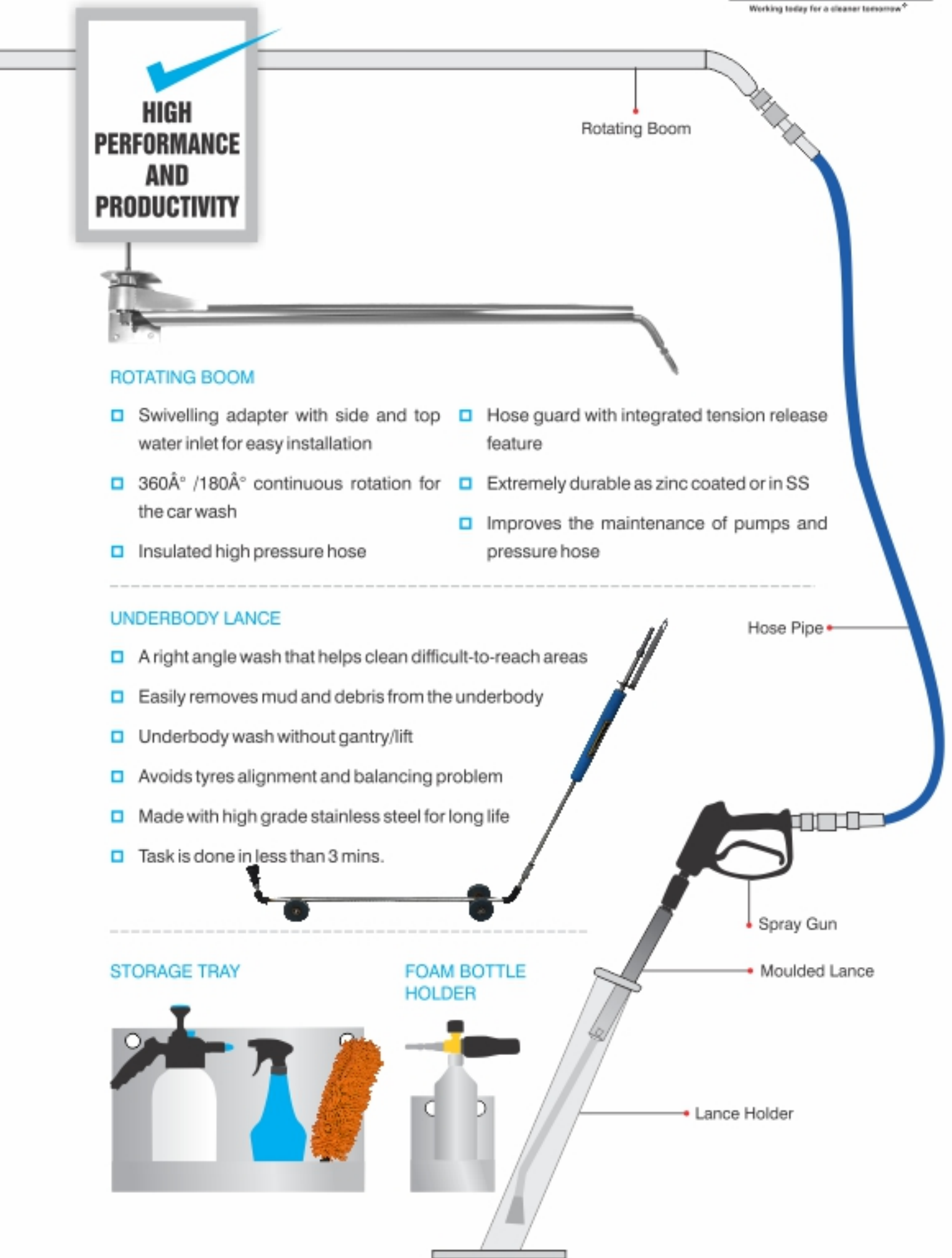
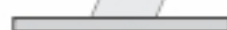

VACUUM CLEANERS

The multi-purpose range of vacuum cleaners are ideal for interiors of the car, workshops, garages and outside areas. An intelligent machine design that's energy efficient and optimized for maximum performance in all applications. The state-of-the-art accessories enhance its suction power and versatility.



ARES 37/1

Wet & Dry Vacuum Cleaner with a single stage motor reaches upto 1400w of maximum power.



TECHNICAL SPECIFICATIONS

Number Motors	1
Stage	double
Volt (V)	220-240
Frequency	50/60
Cooling	by pass
P max (kW)	1400
P (W)	1200
Waterlift (mm H ₂ O)	2400
Air flow (m ³ /h)	215
LpA sonorus 3mt (dB(A))	60
Total tank capacity (lt)	37
Weight (kg)	12,6/13,7

TECHNICAL SPECIFICATIONS

Number Motors	2
Stage	double
Volt (V)	220-240
Frequency	50/60
Cooling	by pass
P max (kW)	2600
P (W)	2300
Waterlift (mm H ₂ O)	2400
Air flow (m ³ /h)	430
LpA sonorus 3mt (dB(A))	67
Total tank capacity (lt)	77/76
Weight (Kg)	22,4/24,0

EXCEL M – 77/2

Ideal for professional cleaning, with two double stage motors reaching upto 2600w of maximum power.



TECHNICAL SPECIFICATIONS

Number Motors	1
Type Motor	turbina 400V-50Hz
Stage	single
P max (kW)	3,0 trifase
Protection IP	54
Tank material	inox 304
Total tank capacity (lt)	75
Waterlift (mm H ₂ O)	2800
Air flow (m ³ /h)	330
Total filtering surface (cm)	17.000
LpA sonorus 3mt (dB(A))	69
Filter shaker	automatic



FORCE VERTICAL

Ideal for intensive and continuous uses. Equipped with a 3.0kw THREE-PHASE Turbine.



SPRAY EXTRACTION

A comprehensive new age range of spray extraction machines that are compact, powerful and manageable. Equipped with a strong suction power and inbuilt detergent tank, they are miraculous performers in wet cleaning, dry cleaning, armchair wash and floor wash.

TECHNICAL SPECIFICATIONS

Number Motors	1
Stage	double
Volt (V)	220-240
Frequency	50/60
Cooling	by pass
P max (kW)	1400
P (W)	1200
Waterlift (mm H ₂ O)	2400
Air flow (m ³ /h)	215
LpA sonorus 3mt (dB(A))	60
Total tank capacity (lt)	37
Capacity pump	0,8
Lift pump (bar)	2
Pump (W)	48
Detergent tank (lt)	8
Weight (kg)	17,6/18,7

ESTRO-125

An extractor with double stage motor that's ideal for applications such a cleaning of car interiors & upholstery. The model is designed with an innovative 8 ltrs. detergent tank to be assimilated to the trolley and completely residual liquids tank.



Plastic tank



Motor



Wet



ESTRO-250

An extractor with double stage motor that's ideal for applications such as cleaning of car interiors & upholstery. The model is designed with an innovative 20 ltrs. detergent tank to be assimilated to the trolley and completely residual liquids tank.



Plastic tank



Motor



Wet

TECHNICAL SPECIFICATIONS

Number motors	2
Stage	double
Volt (V)	220-240
Frequency	50/60
Cooling	by pass
P max (kW)	2600
P (W)	2300
Waterlift (mm H ₂ O)	2400
Air flow (m ³ /h)	430
LpA sonorus 3mt (dB(A))	67
Total tank capacity (lt)	77/76
Capacity pump	0,8
Lift pump (bar)	2
Pump (W)	48
Detergent tank (lt)	20
Weight (kg)	25,5/27,5



Motors



Peripheral electrical pump



Clean carpet & floor vacuum



Solenoid pump



Hot water



STEAM JET CAR CLEANING & WAX SYSTEM

ADVANTAGES OF STEAMJET CARWASH

- ❑ High- pressure steam using only 400cc (130z) water per minute, generating NO wastewater, NO sewage.
- ❑ System consumes less than 200-watt power and minimum fuel.
- ❑ Commercial grade equipment that runs all day non-stop.
- ❑ Stainless steel and rust proof structure.
- ❑ CPU controlled with 8 different phases of automatic safety features.
- ❑ 28 levels of steam moisture control in a well-modulated system.

FX1-D (DIESEL MODEL)

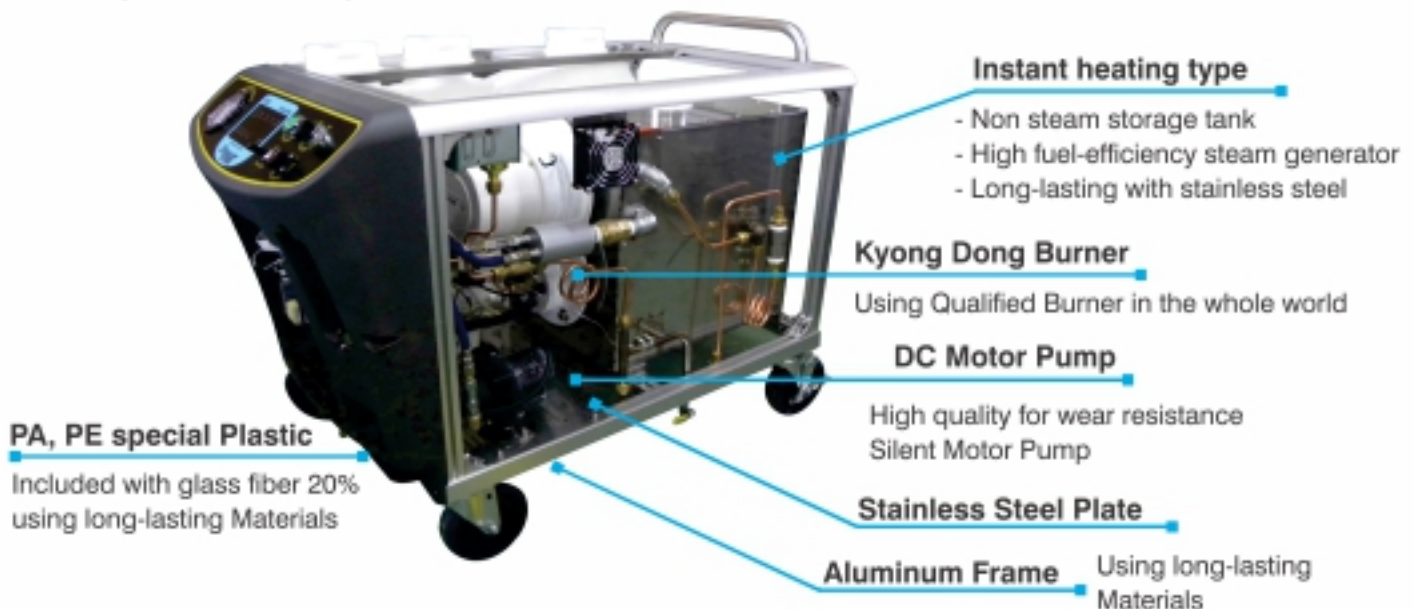

TECHNICAL SPECIFICATIONS

- ❑ Dimension :540 x 909 x 750 (mm) (W x L x H)
21.3 x 35.6 x 29.5 (inch) (W x L x H)
- ❑ Hose Length: 10 meters
- ❑ Weight: 67 kg (147.7lbs)
- ❑ Water tank capacity: 211 liters (5.5gal)
- ❑ Wax tank capacity: 6.5 liters (1.7gal)
- ❑ Diesel fuel tank capacity: 6.5 liters (1.7 gal)
- ❑ Electric power rate: 110~220V (SO/60hz)
- ❑ Electric power consumption: 200W
- ❑ Steam generator: Open (instant) type (patent)
(non boiler type)
- ❑ Steam pressure: 6~8 Bar / 116-145psi
- ❑ Steam temperature: 80~90 C (176~203 F)
- ❑ Preheating time: 1 minute
- ❑ Water consumption: 650~950cc/min (users can adjust)
- ❑ Materials: stainless steel, aluminum, PA, PE, ABS
- ❑ Automatic wax mixing device: (on/off function)

'M START' AUTOMATIC CAR WASH SYSTEM

'M START' is a rollover designed for wash facilities with a capacity of 400 to 1200 vehicles a month and is the perfect machine for those wishing to start off in the vehicle wash business in the most profitable way.

- ❑ Planned for wash facility with a capacity of 400 to 1200 vehicles a month.
- ❑ Structure made from hot deep galvanized steel and assembled using clinching process.
- ❑ Strong framework and environment friendly cleaning agents.
- ❑ LCD screen control panel with a storage capacity of up to 30 programs.
- ❑ Brushes and dryer driven by drive motors for better cleaning and drying effect.
- ❑ A maintenance free machine.
- ❑ Frequency invertors on the brushes and dryer enabling optimum use of chemicals and low electricity consumption.

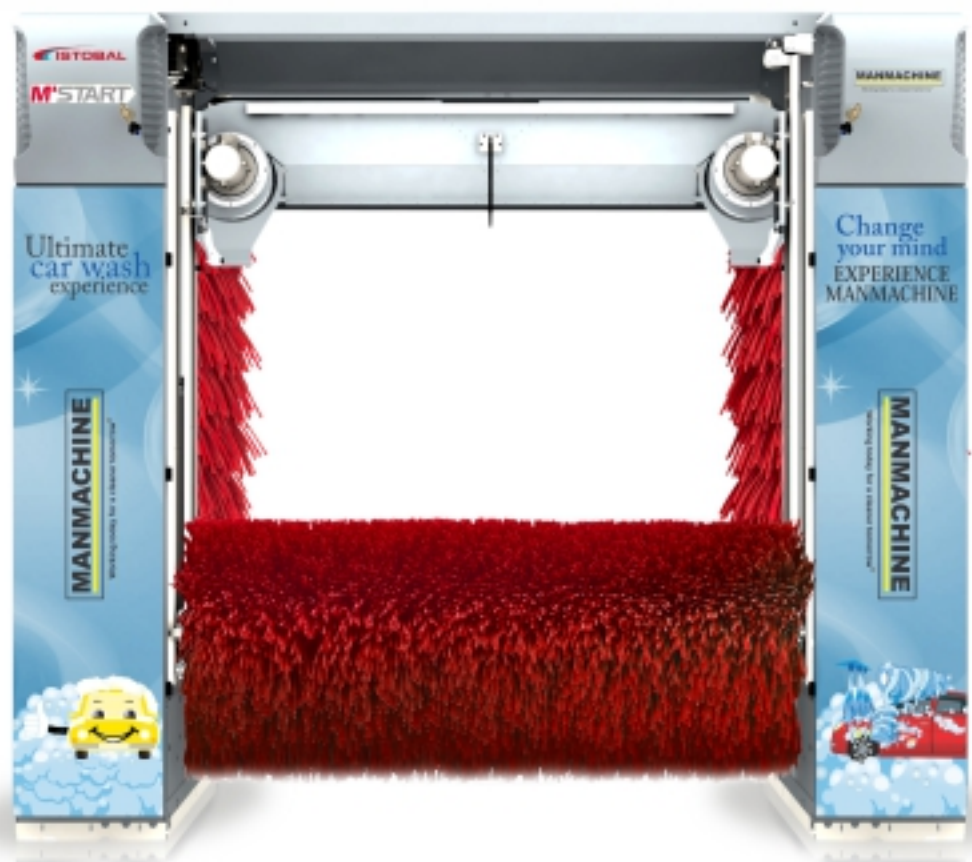

TECHNICAL SPECIFICATIONS

WASH DIMENSIONS

WASH HEIGHT	2,300	2,500	2,700
WASH WIDTH	2,400	2,400	2,400
LENGTH OF RAILS	9,000	9,000	10,000
MINIMUM MACHINE WIDTH*	3,800	3,800	3,800
MAXIMUM MACHINE WIDTH**	4,212	4,212	4,212
TOTAL MACHINE HEIGHT	3,083	3,313	3,513

All measurements in mm.



Manmachine brings you a superior range of specialized cleaning agents and treatments that are eco-friendly and safe for vehicles, car equipments and human hands.

COMPLETE LINE OF CAR WASH CHEMICALS AND NEW TREATMENTS

- Foam
- Colored Foam Wash
- Self-drying Wax
- Shampoo
- Paint Protection Coating
- Rubbing & Waxing
- Micro-fiber Cloth
- Windshield Coating
- Fabric Protection
- Leather Conditioning
- Car Deodorization
- Cavity Anti-rust Treatment





BEST-IN -CLASS SERVICE WITH EXPERT SUPPORT & TRAINING

Highly focused towards 100% customer satisfaction, our nationwide network of service centers provide support throughout the complete product lifecycle ensuring high performance and reliability.

Car Wash College is an initiative to provide professional training to the operators and keep them abreast on latest techniques through programs conducted regularly.

Through a collaborative learning environment, the operators are trained for proficiently handling all aspects of machinery and generate the combined force of man and machine.

Knowledge of chemicals, new treatments and their usage.

To achieve minimum costs per car wash through optimum usage of cleaning agents and other specialized treatments.

Step by step car wash process.

Delivering the car on a 20 point checklist to achieve the desirable customer satisfaction index(CSI).

Preventive measure for long life maintenance of machines.

Just 5 days of training upgrades their skills in complete car cleaning and care.

**“We don't sell equipment
we build relationships”**





CHANGE YOUR MIND
EXPERIENCE MANMACHINE

MANMACHINE GROUP

Corporate Office : E - 98, Sector 6, Noida - 201 301
Ph : 0120 - 4256161 / 4256262 Fax : 0120 - 4256363
E-mail : info@manmachine.in | www.manmachine.in

DEALER: